



## 1. Battery Installation

1.1 Insert battery

## 2. Operating Instruction

### 2.1 Unlocking

2.1.1 For private version

2.1.2 For public version

### 2.2 Locking

2.2.1 For private version

2.2.2 For public version

### 2.3 Change code (only for private version)

2.4 If password forgotten

## 3. Other Instruction

3.1 Acoustic & optic notifications

3.2 Technical Parameters

## 4. Installation guide

### SISO A/S

Mileparken 11  
DK-2740 Skovlunde  
Denmark

Phone +45 45 830 900  
Fax +45 45 830 444

www.siso.dk  
siso@siso.dk

VAT: DK 24786013

# Electronic Combination Cam Lock "Dave"



## 1. Battery Installation

### 1.1 Insert battery

Battery type CR1220 (not included), remove the battery cover by inserting the needle (included with the accessoires) in the lock hole (A) and pulling out the battery cover carefully (B). Place the battery (C) in the holder and push back the cover in place.



## 2. Operating Instruction

### 2.1 Unlocking

#### 2.1.1 For private version (the Factory default code is "3")

Enter "User code + OK" and hear a long sound "Ti~", then rotate the knob to unlock within 3 seconds.

#### 2.1.2 For public version (the Factory default code is "123")

Enter "User code + OK" and hear a long sound "Ti~", then rotate the knob to unlock within 3 seconds. (Remark: the code will automatically be deleted after use, so the next user can use their own new code.)

### 2.2 Locking

#### 2.2.1 For private version

Rotate the knob anticlockwise to the exact position to lock.

#### 2.2.2 For public version

Enter "user code + OK" first. (the user code can be set by any combination of 1,2,3, and ranging from 3 to 6 digits). The rotate the knob anticlockwise to lock.

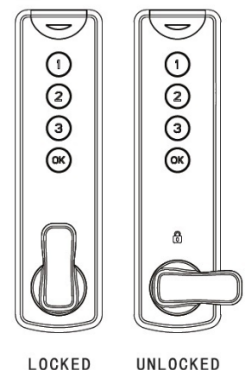

### 2.3 Change code (only for private version)

Input "Old code + OK + OK + new code + OK", then you can hear a long sound "Ti~", which means the new code is set successfully. For example: change the default code from 3 to 123 >> input "3 + OK + OK + 123 + OK", then you can hear a long sound "Ti:~", that means the new code comes into effect.

### 2.4 Forgotten password

#### For Private version:

Enter Reset code\* "xxxx-xxxx-xxxx-xxx" then press OK button, the lock is reset to factory status. Use now the factory default user code 3 + OK button and then turn the knob - You can now set your personal code.

#### For Public version:

Enter Reset code\* "xxxx-xxxx-xxxx-xxx" then press OK button, the lock is reset to factory status. Use now the factory default user code 1+2+3 + OK button and then turn the knob - Now the lock is ready to be used by the next guest/customer.

\*For "Reset" code: please note your serial number (on right side of the lock) and contact your lock supplier to get the "Reset" code.

The "Reset" code is only valid 1 time. You can get 1 "Reset" code every 24 hours. When entering the "Reset" code type the numbers WITHOUT any space/lines between the numbers

## SISO A/S

Mileparken 11  
DK-2740 Skovlunde  
Denmark

Phone +45 45 830 900  
Fax +45 45 830 444

www.siso.dk  
siso@siso.dk

VAT: DK 24786013

## 3. Other instructions

### 3.1 Acoustic & optic notifications

No	Name	Sound notification	Explanation
1	Button	Ti-- short sound	The "keypress" is effective
2	Unlocking change	Ti----long sound	Operation correct. Unlocking/change code successfully
3	Error	Ti Ti two sounds	Operation, error, input failure
4	Low power	Ti Ti Ti three sounds	Low power, replace a new battery
5	Alarm	Ti... alarm sounds	3 times wrong input will cause alarm sound for 60 seconds

Note 1: Replacing battery when it is in low power - during the low power condition, user can still unlock for 500 times.

Note 2: Three times input the code incorrectly will cause alarm sounds for 60 seconds. Once the correct code has been put in, the alarm will stop.

### 3.2 Technical parameters

Working voltage	DC 2.3-3.3V
Battery SPEC	CR 1220
Standby current	≤ 2uA
Max. current	≤ 5mA and time of duration ≤ 35ms
Battery life	1-2 years unlock 30-50 times one day
Operation temp	-5 degrees to +50 degrees Celsius
Relative humidity	20% to 80%
Material	Zinc Alloy/ABS
Diameter of mounting	Apply to diameter 16mm
Panel Thickness	Steel: 0,5-12mm Wood: 0,5-22mm
Certification	CE/FCC/PSE/ROHS/SGS/SST

#### SISO A/S

Mileparken 11  
DK-2740 Skovlunde  
Denmark

Phone +45 45 830 900  
Fax +45 45 830 444

www.siso.dk  
siso@siso.dk

VAT: DK 24786013

## 4. Installation guide

### 1 : 1 Hole drawing

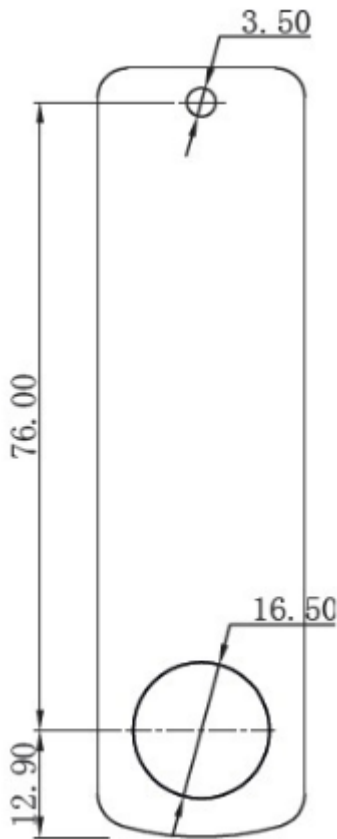

### Assembling drawing

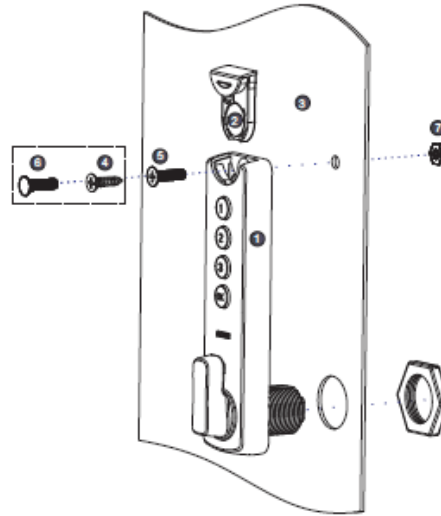

### Accessories

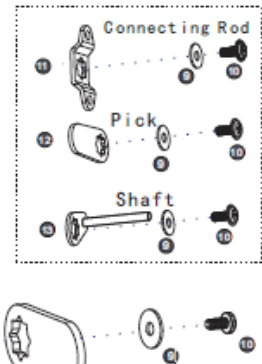

### List of accessories

- 1 Lock
- 2 Battery holder
- 3 Door panel Wood: 10-22mm / Iron: 0.5-12mm
- 4 Bolt x3 (PA3.0\*12 for wood only)
- 5 Bolt x1 (KM3.0\*12 for steel only)
- 6 Bolt x2 (M3.0\*12 & M3.0\*25)
- 7 Nut x1 (M3.0 for steel only)
- 8 Nut x1 (M16)
- 9 Spacer for accessories x1 (Ø12mm)
- 10 Bolt x1 (PWM4.0\*8mm)
- 11 Connecting Rod x1
- 12 Pick x1
- 13 Shaft x1
- 14 Pipe x1
- 15 Block x1
- 16 Needle x1

### SISO A/S

Mileparken 11  
DK-2740 Skovlunde  
Denmark

Phone +45 45 830 900  
Fax +45 45 830 444

www.siso.dk  
siso@siso.dk

VAT: DK 24786013